

# IMPORTANT INSTRUCTIONS

## For Installation of Fitting LS275A-2

**MODELS** LS275A-2 Star  
12V 75watt max. MR16 lamp  
IPx8 rated 1.5m class 3

 **UL** US  
LISTED  
LOW VOLTAGE FIXTURE  
1F30

   
A.C.N. 010 572 773

### WARNING

DO NOT SHORTEN, INTERFERE OR DISCONNECT CABLE FROM FITTING. WARRANTY WILL BE VOID IF CABLE ASSEMBLY IS TAMPERED WITH.

### 1 INSTALLATION - LS275A-2 STAR

#### SUBMERSED BEFORE LIGHTING

1. Fit lamp as in re-lamping instructions (below and Fig. B).
2. Mount Base Plate using a suitable non-corrosive fastener. Two 6mm Stainless Steel Dynabolts are recommended for concrete mounting.
3. Fit fixture to Base Plate locating the stud in the BasePlate slot and tighten wingnut.
4. Run the cable out and connect to an isolating type transformer.
5. Do not loose joint the cable under water. Joint should either be in an approved enclosure or out of the water.
6. Ensure that the supply voltage is 12 volts before switching on.
7. Aim fixture and tighten wing nut.

### 2 RE-LAMPING INSTRUCTIONS - LS275A-2 STAR

1. Loosen wingnut and remove from BasePlate.
2. Lift the fitting from the water.
3. Remove the 4 stainless steel phillips head screws that retain the cover and lift off.
4. Remove the stainless steel circlip in the cover that retains the lamp.
5. Pull the holder off the lamp pins.
6. Inspect the lamp pins for burning. If there appears to be burnt pins replace the lamp holder using the LS275A-2 lamp holder replacement kit.
7. Fit the lamp holder onto the new lamp ensuring that it seats all the way on the lamp pins.
8. Fit lamp holder onto the front cover and refit the stainless steel circlip into its correct groove.
9. Inspect the seal and ensure that it is in good condition and correctly fitted.
10. Fit the cover to the body and replace all 4 stainless steel phillips head screws and tighten.
11. Replace in the water before lighting.

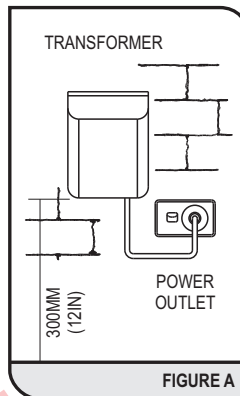

#### Warning:

Use an isolating transformer and over current protection for the secondary circuit in accordance with the National Electric Code.

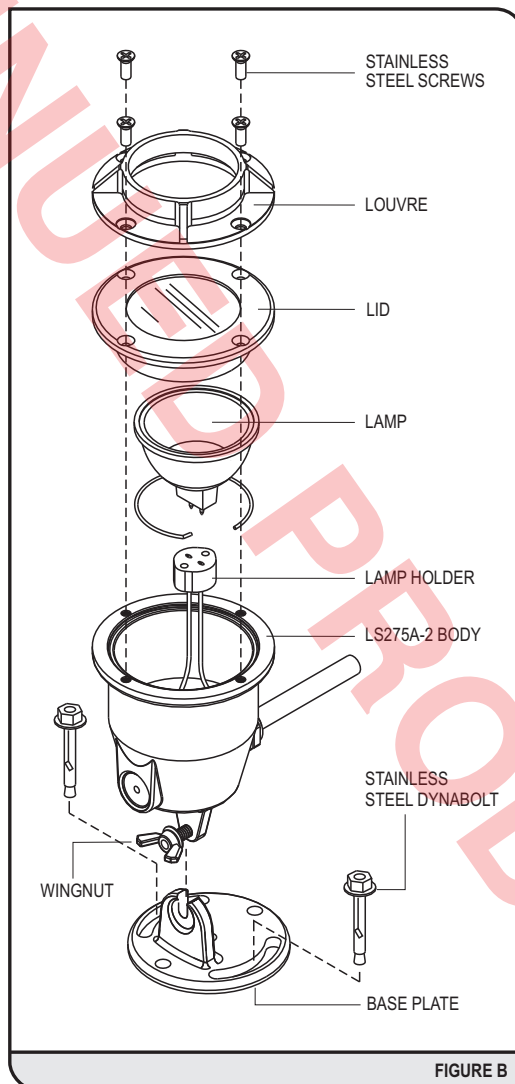

LUMASCAPE  
USA INC.

LUMASCAPE USA INC.

US Head Office  
1300 Industrial Rd., Unit #19  
San Carlos, CA 94070  
USA

Telephone  
1-(650)-595-LUMA(5862)

Fax  
1-(650)-595-5820

[www.lumascope.com](http://www.lumascope.com)

Free Call

1-866-695-LUMA(5862)  
(US & Canada)